

**PŘEKLAD**  
 dne: 23-02-2011  
**PROVEDLÍ**  
*Bočeková m.*

*SKL*  
 7.12.2010

*SKL*  
 7.12.2010

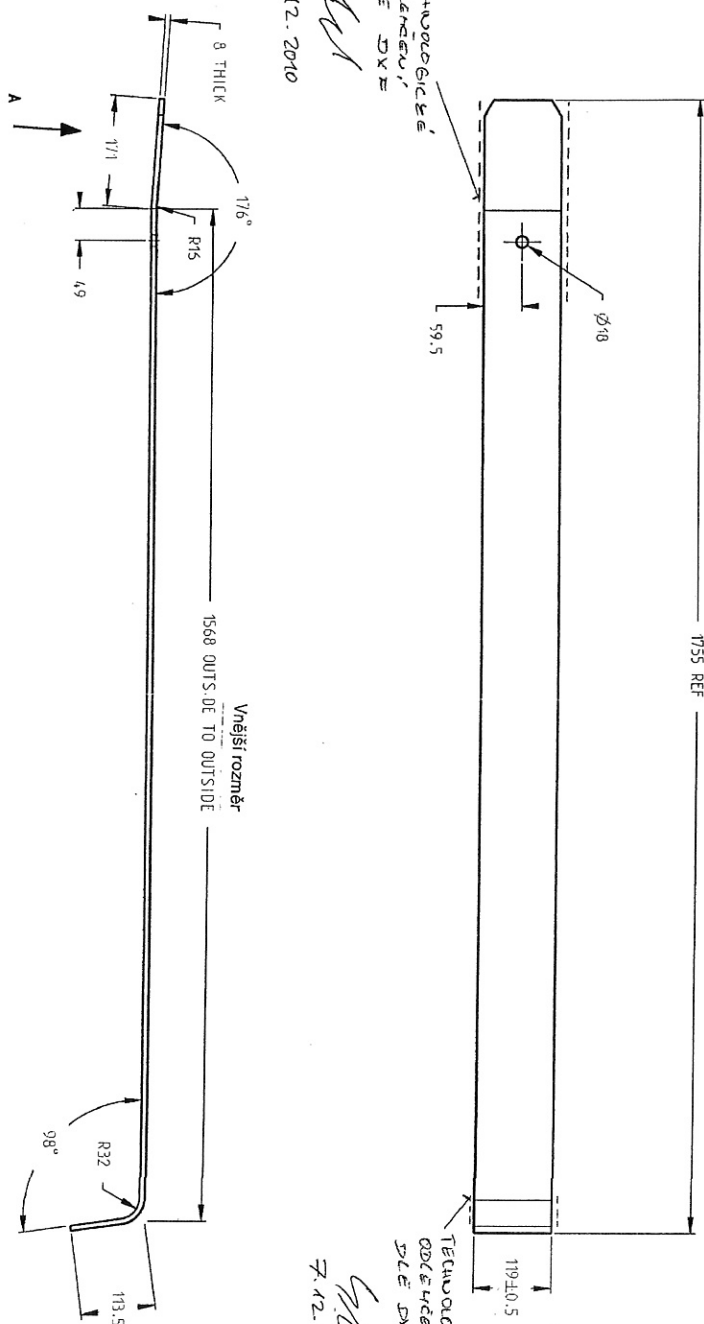

NOTE:  
 REMOVE ALL BURRS AND SHARP EDGES  
 Poznámka:  
 Odstranit ostřiny a vše zhný ostře hrany

① ZH/16/100519 ZHĚNÁ SÁZEŇ  
 z 25x30 NA 10x45° 6.5.2016  
*1.1 pros. 2009*

- 6-05-2016  
**ARCHIV**

TECHNICAL DATA				MATERIAL			
NAME	NO.	REV.	DATE	NAME	NO.	REV.	DATE
1	1	1	1.1.2016	1	1	1	1.1.2016
2	2	2	2.2.2016	2	2	2	2.2.2016
3	3	3	3.3.2016	3	3	3	3.3.2016
4	4	4	4.4.2016	4	4	4	4.4.2016
5	5	5	5.5.2016	5	5	5	5.5.2016
6	6	6	6.6.2016	6	6	6	6.6.2016
7	7	7	7.7.2016	7	7	7	7.7.2016
8	8	8	8.8.2016	8	8	8	8.8.2016
9	9	9	9.9.2016	9	9	9	9.9.2016
10	10	10	10.10.2016	10	10	10	10.10.2016
11	11	11	11.11.2016	11	11	11	11.11.2016
12	12	12	12.12.2016	12	12	12	12.12.2016

- 8 pros 2010

47/19

23-02-2011  
PROVEDLA

Sud



7.12.2020

5/2/1

ARCHIV  
- 6 - 05 - 2016

# NAHRAZUJE ORIGINÍ

Z 25x30° N/A 10x45° 6.5.2016 <sup>107</sup> pros. 2009

RESEARCH REPORT BY INDEPENDENT LABORATORY	DATE	NO.	QNTY	UNIT	PRICE
	TD	100	100	1000	10000
	TD	100	100	1000	10000

1.5

1 OF 1

THICK STEEL PLATE  
TO EN 10028 S235JR

--	--	--	--	--



--	--	--	--





[illegible]



--	--	--	--	--

\_\_\_\_\_

	PROJECT	DATE
	APPROVED	SIGNATURE

COVENTRY

PLECH SPEDNI	Part No.	T101479	QTY	1
--------------	----------	---------	-----	---

---

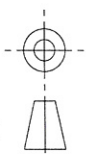

THIRD ANGLE PROJECTION

IF IN DOUBT ASK

VŠECHNY ROZMĚRY V MĚRITELNOSTI MM UNLESS OTHERWISE STATED

PŘEKLAD

27-09-2006

PROVEDLA  
JANA PROSEKALOVA

Rev.	Qty	Revision	Date	Rev.	App. By
A	1	ORIGINAL - CC17419	06/08/15TBE		
2	1	CC17965	22/12/15WFZ		
3	1	CC18491	31/03/16WFZ		
4	1	CC18619	26/08/16JEU		

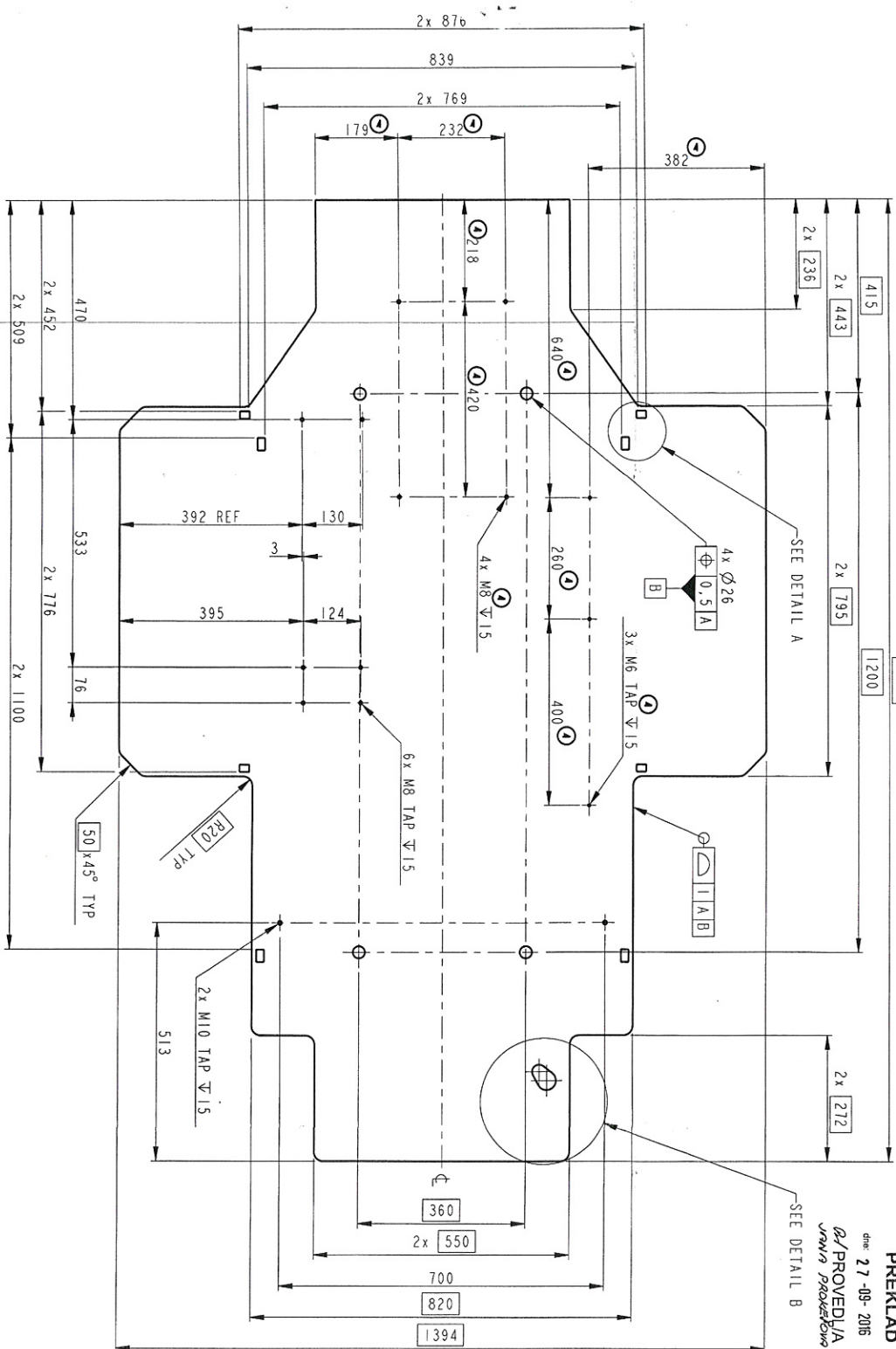

APPROX. MASS = 232 kg  
CUT LENGTH: 7651 mm  
SURFACE AREA: 1973939 mm sq

ПРИБЛИЖИТЕЛЬНАЯ МАССА  
ДЛИНА ОТРЕЗКА = 7651 мм  
ПОВЕРХНОСТНАЯ ПЛОЩАДЬ = 1973939 мм²

- NOTES:-
1. REMOVE ALL BURRS & SHARP EDGES
  2. TOLERANCES UNLESS OTHERWISE STATED:-  
LINEAR UP TO 1000 ±0.5  
OVER 1000 ±1  
ANGLES ±0°30'

- POUZE:-
1. OSTRANIT VŠECHNY OSTRÉ HRANY.
  2. TOLERANCE POKUD NENÍ UVEDENO JINAK  
DÍLČINY POKUD NENÍ UVEDENO JINAK  
PŘES 1000 ±0.5  
PŘES 1000 ±1  
ÚHLY ±0°30'

27/16/07010

-6-10-2016  
ARCHIV

2

DETAIL B

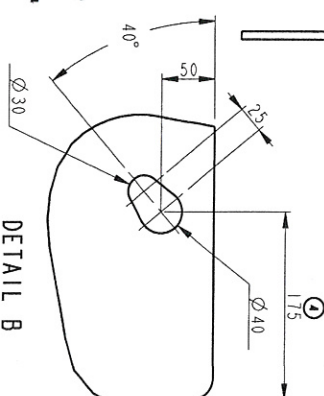

DETAIL A

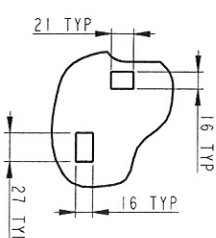

Material	EN10025 S355J2	Dimension	15 THK	Remark	PLATE
Design by	DRF	Checked	Standard	Affirmed	Scale
HR12 MK2	HR12 MK2	Checked	Standard	Affirmed	Scale
BASE PLATE	BASE PLATE	Checked	Standard	Affirmed	Scale

Rev.	Qty	Revision	Date	Rev.	App. By
A	1	ORIGINAL - CC17419	06/08/15TBE		
2	1	CC17965	22/12/15WFZ		
3	1	CC18491	31/03/16WFZ		
4	1	CC18619	26/08/16JEU		





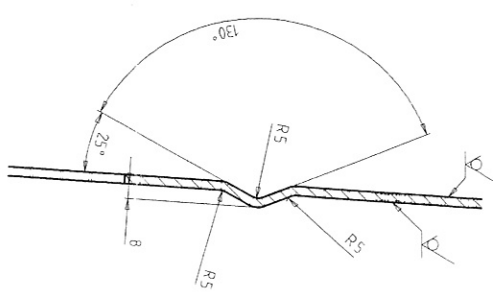

Useful reference site ON 2102-5-1 up to 3m / K over 3m	Additional Text	Spec /
Maj-Nr	Doc-Nr	Version
	20000087/68	03

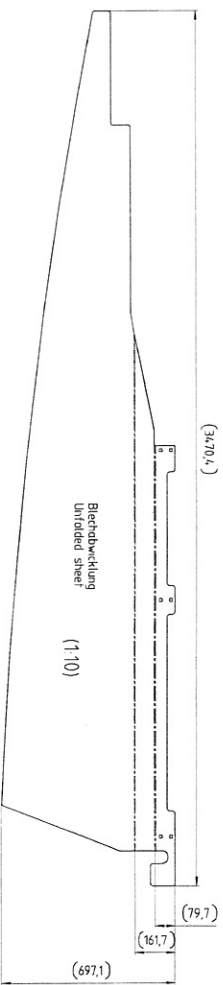
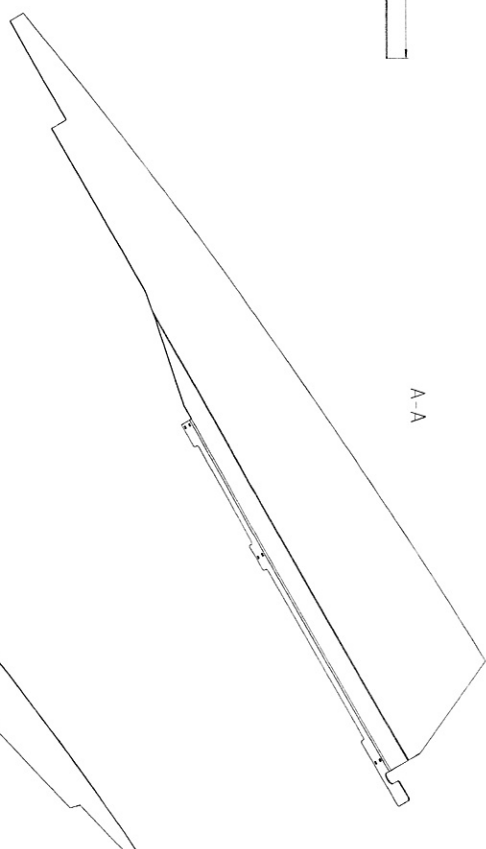
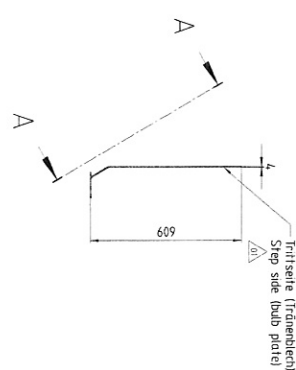
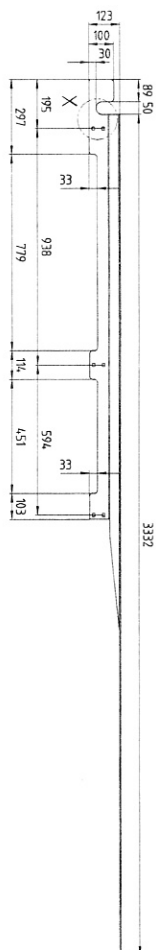
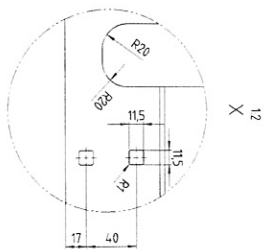

For production-related reasons, the part can also be welded together from single components. Finished dimensions are binding.

[illegible]
$$\sqrt{\frac{B_{100}}{K_{WN}}} = \sqrt{\frac{2100}{2106975}}$$

NE 44/00592

- 5 - 05 - 2014  
ARCh.IV

**FOOTNOTES**

TYPE	DESCRIPTION	WGS	SIN
UGD	4646351	01	S
WEIGHT			
46.5 KG			
HEIGHT			
170			
SEX			
M			
HAIR COLOR			
BROWN			
EYES			
BROWN			
TEETH			
GOOD			
MARKS			
NONE			
REMARKS			
DATE			
NOV 1981			
TIME			
02			
TEST NO.			
2350513			
REP			
01			

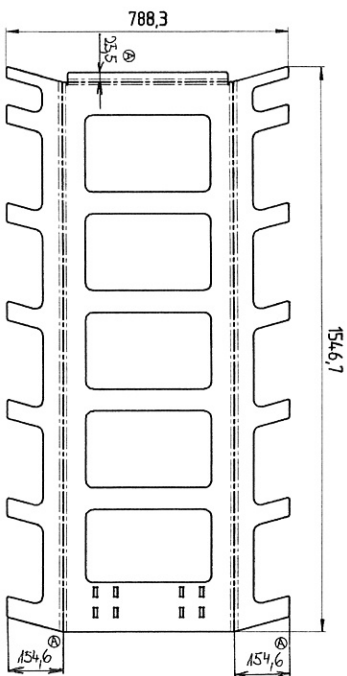



Blechabwicklung  
Unfolded sheet

(1:10)

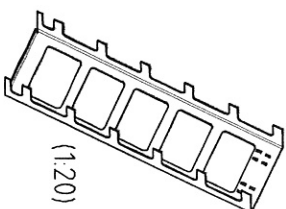
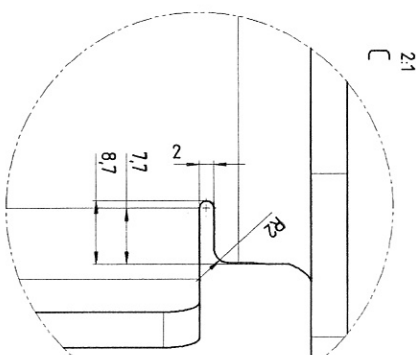
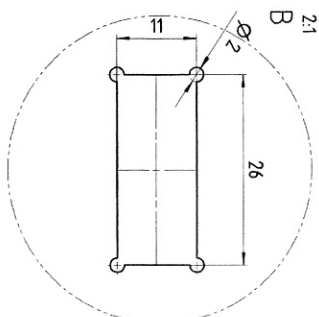
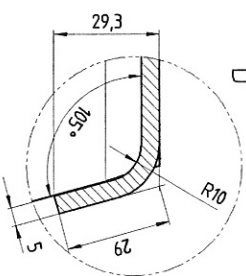
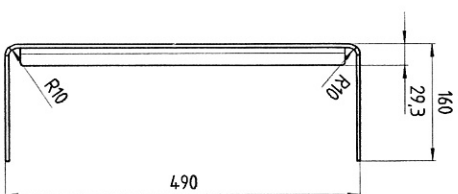
Fertigungsteile sind verbindlich  
 Maße der Abwicklung nicht bindend  
 Abwicklung dem Konstruktoren angepasst  
 Important: Finished dimensions are  
 binding. The drawing must be  
 adapted according to the edge method.  
 Teil kann aus fertig. techn. Gründen auch  
 aus Einzelteilen zusammengeschnitten werden.  
 Zeichnungsmaße sind bindend.



Schutzmerkmal ISO 16076 beachten / Copyright reserved ISO 16076									
EN ISO 17112	MF	Revised					28634	Discovered by	14565127 / 01
EN ISO 13920	BF	Revised by	Approved by	Tested by	Test No				
EN ISO 8662	CT10	Rev. 02.03.13	04.09.2010	03.05.2010					
EN ISO 9013	111	ISO 9000	EN ISO 9001	EN ISO 9001					
EN ISO 1001		Test Method							
EN ISO 1802									
<p>Wanne Treppe Aufstieg FR II MR EV02</p> <p>Bin stair FR II MR EV02</p> <p>Page 28</p>									
		Type weight		Scale		Form			
		23,8 kg		A2		15			
		K108							
				1 / 1					

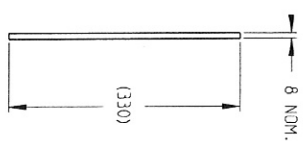
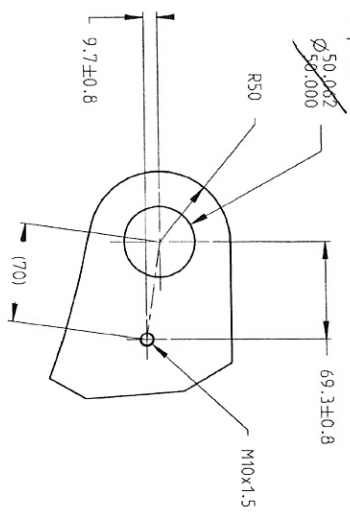
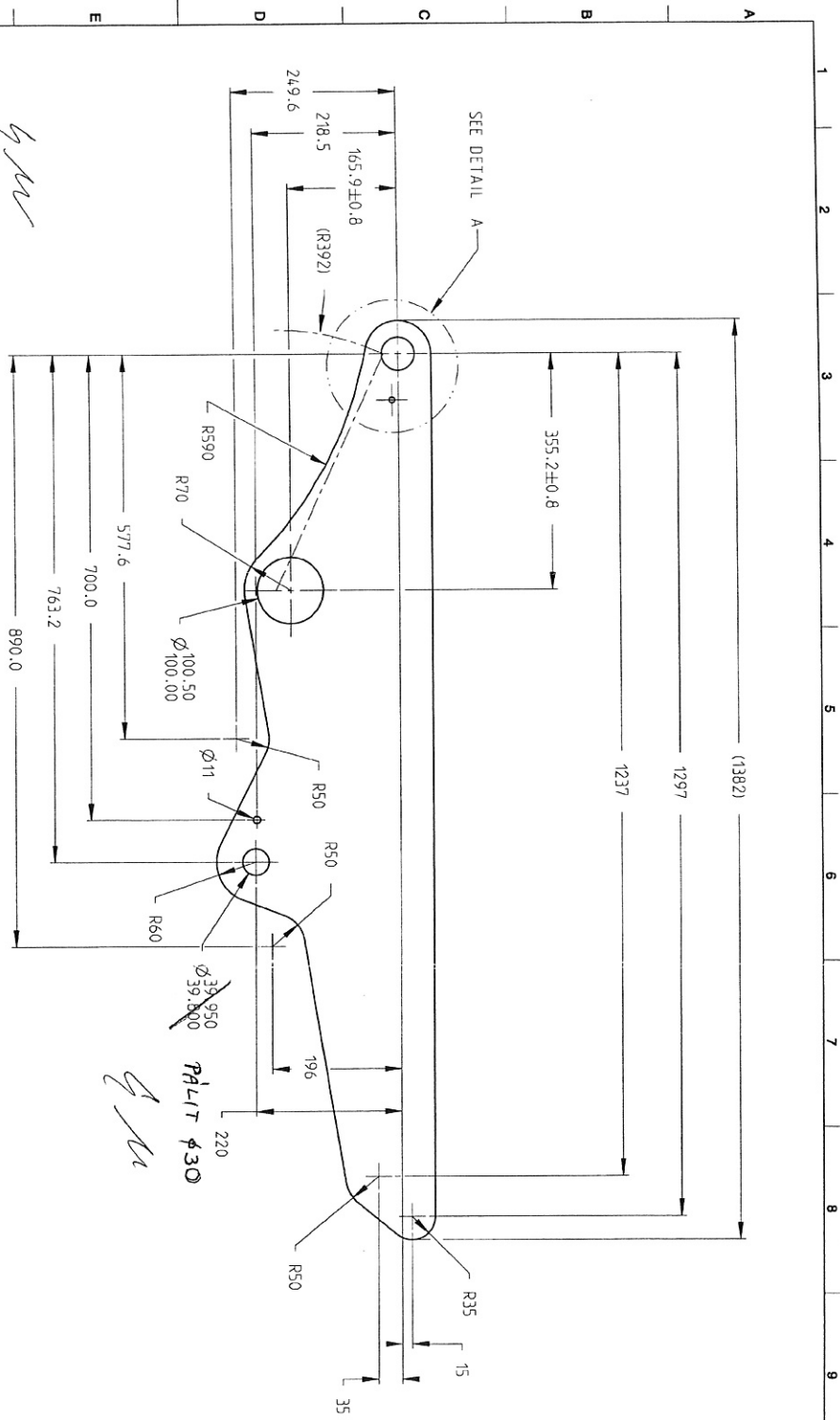

NAHRAZUJE ORIGIN/

- 5 - 11 - 2010

ARCHIV

20.08.2011

TECHNICAL DATA									
DESIGN NO.	6112740M1	REV.	2	DATE	2010	SCALE	2.5	UNIT	mm
DESIGNER	NAHRAZUJE	CHECKED		DATE	2010	SCALE	2.5	UNIT	mm
APPROVED		DATE		SCALE		UNIT			
MATERIAL DATA									
MATERIAL	STEEL	GRADE	A2	THICKNESS	16.9 kg	UNIT	kg	SCALE	2.5
MANUFACTURING DATA									
MANUFACTURER	NAHRAZUJE	DATE	2010	SCALE	2.5	UNIT	mm		

TECHNICAL DATA									
DESIGN NO.	6112740M1	REV.	2	DATE	2010	SCALE	2.5	UNIT	mm
DESIGNER	NAHRAZUJE	CHECKED		DATE	2010	SCALE	2.5	UNIT	mm
APPROVED		DATE		SCALE		UNIT			
MATERIAL DATA									
MATERIAL	STEEL	GRADE	A2	THICKNESS	16.9 kg	UNIT	kg	SCALE	2.5
MANUFACTURING DATA									
MANUFACTURER	NAHRAZUJE	DATE	2010	SCALE	2.5	UNIT	mm		

17/1/19

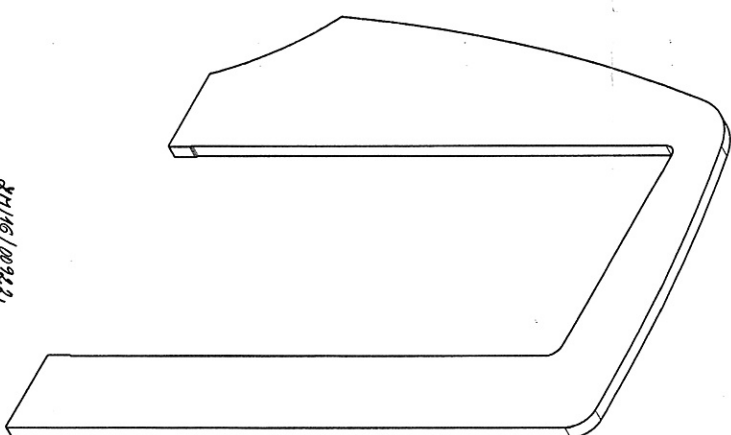

Stempelfeld fuer  
Kennzeichnung mit:  
Ident.-Nr.

[illegible]



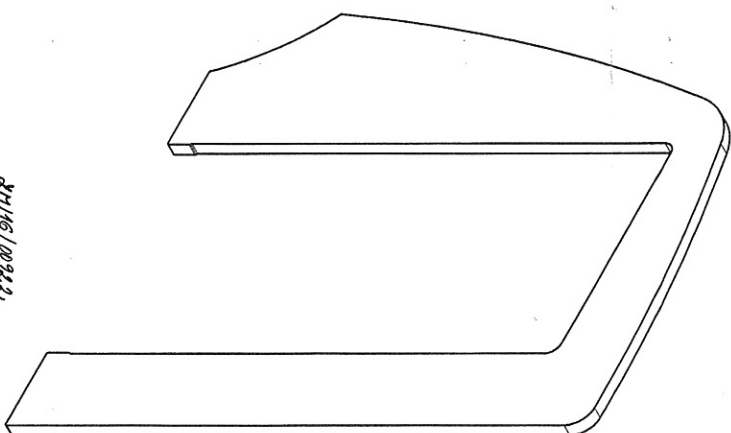

Material-Nr.	Ident-Nr.	Benennung	UW	L	Datum/Beach.
5272407112	82885808	AB-980 Trög 134	306	704,4	54
5272407113	82885809	AB-980 Trög 136	416	704,4	56
5272407123	-	AB-980 Trög 134 mit Gewinde siehe Blatt 2	306	704,4	54
5272407124	-	AB-980 Trög 136 mit Gewinde siehe Blatt 2	416	704,4	56

Stempelfeld fuer  
Kennzeichnung mit:  
Ident.-Nr.

[illegible]

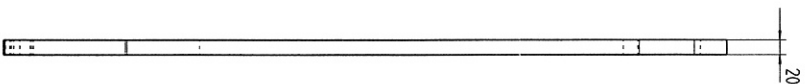

70

70

**M** Stempel/feld fuer  
Kennzeichnung mit:  
Material-Nr.

<p>Die flache Ausladung -gestrichelt- -Schnitzverfahren und Glat von den Schnittkanten entfernt</p>	<p>At-Faserung</p>
<p>Profilansicht</p>	<p>Profilansicht</p>

Brennschnitt

Schweißgüte nach EN ISO 9013	
Bezeichnung	Gründungstiefe für Normmaße
35	375
1000	200

	$\pm 35$	$\pm 1000$	$\pm 2000$	$\pm 4000$
3 - 12	$\pm 10$	$\pm 15$	$\pm 20$	$\pm 31$
12 - 50	$\pm 05$	$\pm 10$	$\pm 15$	$\pm 27$

A	100	200	300	400	500	600	700	800	900	1000
100 - 200	0.10	0.20	0.30	0.40	0.50	0.60	0.70	0.80	0.90	1.00
200 - 300	0.10	0.20	0.30	0.40	0.50	0.60	0.70	0.80	0.90	1.00
300 - 400	0.10	0.20	0.30	0.40	0.50	0.60	0.70	0.80	0.90	1.00
400 - 500	0.10	0.20	0.30	0.40	0.50	0.60	0.70	0.80	0.90	1.00
500 - 600	0.10	0.20	0.30	0.40	0.50	0.60	0.70	0.80	0.90	1.00
600 - 700	0.10	0.20	0.30	0.40	0.50	0.60	0.70	0.80	0.90	1.00
700 - 800	0.10	0.20	0.30	0.40	0.50	0.60	0.70	0.80	0.90	1.00
800 - 900	0.10	0.20	0.30	0.40	0.50	0.60	0.70	0.80	0.90	1.00
900 - 1000	0.10	0.20	0.30	0.40	0.50	0.60	0.70	0.80	0.90	1.00

Form- und Logikdifferenz (F'L)	
Maßstab:	-30 -120 -400 -1000 -2000 -4000 -8000

FT	0.5	0.8	1.2	2	3	4	5
----	-----	-----	-----	---	---	---	---

Form und Lage ISO 1101

○ Randzeit = fDurchm.-Td.  
+ < - □ ⊙ / ⇌ // ⊕ ∓ T

Sprachen:	de
-----------	----

5	
---	--

[illegible]

17 - 10 - 2013  
ARCHIV  
3

113070VANZ' POLOMÉRY R=3  
Nicht bemalte Radien R=3

NZ 73/00832

Blatt 3 hinzu und	153754	

Modellen-Nachtrag	24.12.2017	116

Änderungsbeschreibung	Änd.-Nr.	Fassmodell	Alt

large	<input type="checkbox"/>	Werkstoff:	BL20A-EN10029,S235JR-EN10025-2
small	<input type="checkbox"/>	521021212	
Part-Nr.		Reibteil-Nr.	

0.0	Benennung: SZ	Driftm	INCINE
		23.8.2013	
		HKerthner	
		0.0	

Seitenteil	AB 090 TE
SER	115

	AD-70V, 1C	MALDI
ppm.	169.2013	Kr (QESCI)
		er

[illegible]

8288157 / STILL-RT

Vertrauliche Unterlage	Zeichn.	52128086060	Vor
------------------------	---------	-------------	-----

Freigegeben	5212803606001
-------------	---------------

---

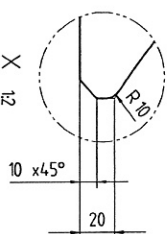
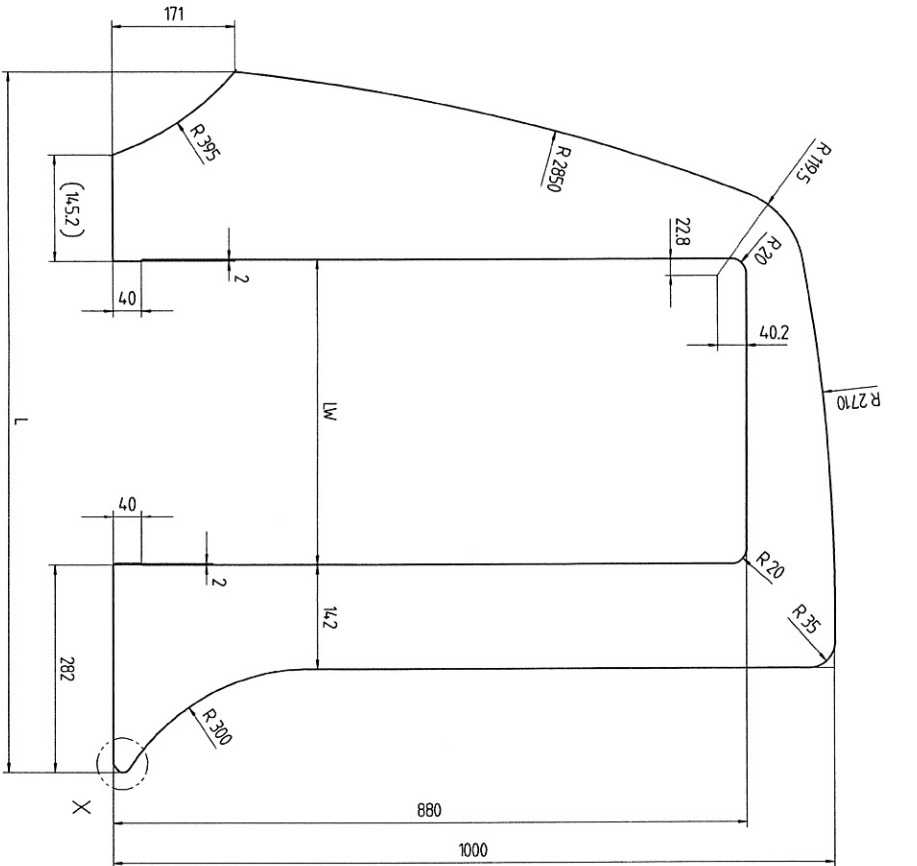

Ident.-Nr.	Matr.-Nr.	Benennung	LW	L	Gewicht (kg)	Blatt	Änd. od. Nach. / Revision	Datum/Beerb.
8288158	5212407104	Seitenstück	306	844,4	58,3	2		
8288159	5212407105	Seitenstück	416	954,4	60,4	2		
-	5212407116	Seitenstück	416	954,4	58	3	TS3754 / 04, Nachtrag 23.08.13 / HKI	

04

Reze. Plo. 24/201  
Zusatz: S. 21.08.13  
HINTERVIA LV

Standard für  
Seitenstück 011

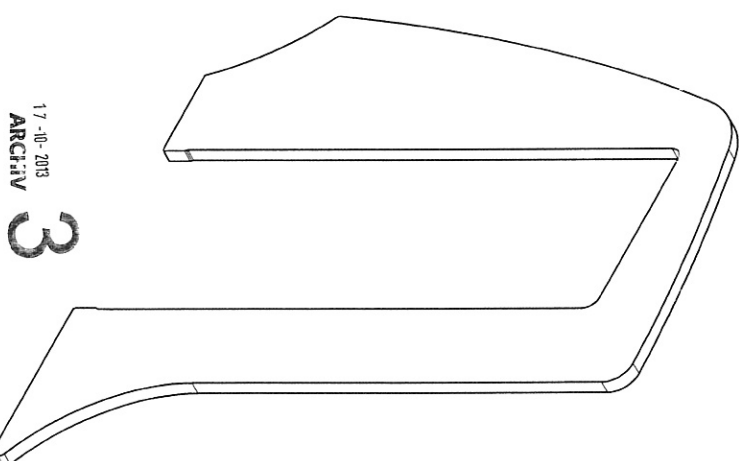

17-10-2013  
ARCHIV  
Nicht benutzte Roden R=3

Nr. 73/00852

<b>Druckausfertigung</b> 1:1 1:2 1:3 1:4 1:5 1:6 1:7 1:8 1:9 1:10 1:11 1:12 1:13 1:14 1:15 1:16 1:17 1:18 1:19 1:20 1:21 1:22 1:23 1:24 1:25 1:26 1:27 1:28 1:29 1:30 1:31 1:32 1:33 1:34 1:35 1:36 1:37 1:38 1:39 1:40 1:41 1:42 1:43 1:44 1:45 1:46 1:47 1:48 1:49 1:50 1:51 1:52 1:53 1:54 1:55 1:56 1:57 1:58 1:59 1:60 1:61 1:62 1:63 1:64 1:65 1:66 1:67 1:68 1:69 1:70 1:71 1:72 1:73 1:74 1:75 1:76 1:77 1:78 1:79 1:80 1:81 1:82 1:83 1:84 1:85 1:86 1:87 1:88 1:89 1:90 1:91 1:92 1:93 1:94 1:95 1:96 1:97 1:98 1:99 1:100 1:101 1:102 1:103 1:104 1:105 1:106 1:107 1:108 1:109 1:110 1:111 1:112 1:113 1:114 1:115 1:116 1:117 1:118 1:119 1:120 1:121 1:122 1:123 1:124 1:125 1:126 1:127 1:128 1:129 1:130 1:131 1:132 1:133 1:134 1:135 1:136 1:137 1:138 1:139 1:140 1:141 1:142 1:143 1:144 1:145 1:146 1:147 1:148 1:149 1:150 1:151 1:152 1:153 1:154 1:155 1:156 1:157 1:158 1:159 1:160 1:161 1:162 1:163 1:164 1:165 1:166 1:167 1:168 1:169 1:170 1:171 1:172 1:173 1:174 1:175 1:176 1:177 1:178 1:179 1:180 1:181 1:182 1:183 1:184 1:185 1:186 1:187 1:188 1:189 1:190 1:191 1:192 1:193 1:194 1:195 1:196 1:197 1:198 1:199 1:200 1:201 1:202 1:203 1:204 1:205 1:206 1:207 1:208 1:209 1:210 1:211 1:212 1:213 1:214 1:215 1:216 1:217 1:218 1:219 1:220 1:221 1:222 1:223 1:224 1:225 1:226 1:227 1:228 1:229 1:230 1:231 1:232 1:233 1:234 1:235 1:236 1:237 1:238 1:239 1:240 1:241 1:242 1:243 1:244 1:245 1:246 1:247 1:248 1:249 1:250 1:251 1:252 1:253 1:254 1:255 1:256 1:257 1:258 1:259 1:260 1:261 1:262 1:263 1:264 1:265 1:266 1:267 1:268 1:269 1:270 1:271 1:272 1:273 1:274 1:275 1:276 1:277 1:278 1:279 1:280 1:281 1:282 1:283 1:284 1:285 1:286 1:287 1:288 1:289 1:290 1:291 1:292 1:293 1:294 1:295 1:296 1:297 1:298 1:299 1:300 1:301 1:302 1:303 1:304 1:305 1:306 1:307 1:308 1:309 1:310 1:311 1:312 1:313 1:314 1:315 1:316 1:317 1:318 1:319 1:320 1:321 1:322 1:323 1:324 1:325 1:326 1:327 1:328 1:329 1:330 1:331 1:332 1:333 1:334 1:335 1:336 1:337 1:338 1:339 1:340 1:341 1:342 1:343 1:344 1:345 1:346 1:347 1:348 1:349 1:350 1:351 1:352 1:353 1:354 1:355 1:356 1:357 1:358 1:359 1:360 1:361 1:362 1:363 1:364 1:365 1:366 1:367 1:368 1:369 1:370 1:371 1:372 1:373 1:374 1:375 1:376 1:377 1:378 1:379 1:380 1:381 1:382 1:383 1:384 1:385 1:386 1:387 1:388 1:389 1:390 1:391 1:392 1:393 1:394 1:395 1:396 1:397 1:398 1:399 1:400 1:401 1:402 1:403 1:404 1:405 1:406 1:407 1:408 1:409 1:410 1:411 1:412 1:413 1:414 1:415 1:416 1:417 1:418 1:419 1:420 1:421 1:422 1:423 1:424 1:425 1:426 1:427 1:428 1:429 1:430 1:431 1:432 1:433 1:434 1:435 1:436 1:437 1:438 1:439 1:440 1:441 1:442 1:443 1:444 1:445 1:446 1:447 1:448 1:449 1:450 1:451 1:452 1:453 1:454 1:455 1:456 1:457 1:458 1:459 1:460 1:461 1:462 1:463 1:464 1:465 1:466 1:467 1:468 1:469 1:470 1:471 1:472 1:473 1:474 1:475 1:476 1:477 1:478 1:479 1:480 1:481 1:482 1:483 1:484 1:485 1:486 1:487 1:488 1:489 1:490 1:491 1:492 1:493 1:494 1:495 1:496 1:497 1:498 1:499 1:500 1:501 1:502 1:503 1:504 1:505 1:506 1:507 1:508 1:509 1:510 1:511 1:512 1:513 1:514 1:515 1:516 1:517 1:518 1:519 1:520 1:521 1:522 1:523 1:524 1:525 1:526 1:527 1:528 1:529 1:530 1:531 1:532 1:533 1:534 1:535 1:536 1:537 1:538 1:539 1:540 1:541 1:542 1:543 1:544 1:545 1:546 1:547 1:548 1:549 1:550 1:551 1:552 1:553 1:554 1:555 1:556 1:557 1:558 1:559 1:560 1:561 1:562 1:563 1:564 1:565 1:566 1:567 1:568 1:569 1:570 1:571 1:572 1:573 1:574 1:575 1:576 1:577 1:578 1:579 1:580 1:581 1:582 1:583 1:584 1:585 1:586 1:587 1:588 1:589 1:590 1:591 1:592 1:593 1:594 1:595 1:596 1:597 1:598 1:599 1:600 1:601 1:602 1:603 1:604 1:605 1:606 1:607 1:608 1:609 1:610 1:611 1:612 1:613 1:614 1:615 1:616 1:617 1:618 1:619 1:620 1:621 1:622 1:623 1:624 1:625 1:626 1:627 1:628 1:629 1:630 1:631 1:632 1:633 1:634 1:635 1:636 1:637 1:638 1:639 1:640 1:641 1:642 1:643 1:644 1:645 1:646 1:647 1:648 1:649 1:650 1:651 1:652 1:653 1:654 1:655 1:656 1:657 1:658 1:659 1:660 1:661 1:662 1:663 1:664 1:665 1:666 1:667 1:668 1:669 1:670 1:671 1:672 1:673 1:674 1:675 1:676 1:677 1:678 1:679 1:680 1:681 1:682 1:683 1:684 1:685 1:686 1:687 1:688 1:689 1:690 1:691 1:692 1:693 1:694 1:695 1:696 1:697 1:698 1:699 1:700 1:701 1:702 1:703 1:704 1:705 1:706 1:707 1:708 1:709 1:710 1:711 1:712 1:713 1:714 1:715 1:716 1:717 1:718 1:719 1:720 1:721 1:722 1:723 1:724 1:725 1:726 1:727 1:728 1:729 1:730 1:731 1:732 1:733 1:734 1:735 1:736 1:737 1:738 1:739 1:740 1:741 1:742 1:743 1:744 1:745 1:746 1:747 1:748 1:749 1:750 1:751 1:752 1:753 1:754 1:755 1:756 1:757 1:758 1:759 1:760 1:761 1:762 1:763 1:764 1:765 1:766 1:767 1:768 1:769 1:770 1:771 1:772 1:773 1:774 1:775 1:776 1:777 1:778 1:779 1:780 1:781 1:782 1:783 1:784 1:785 1:786 1:787 1:788 1:789 1:790 1:791 1:792 1:793 1:794 1:795 1:796 1:797 1:798 1:799 1:800 1:801 1:802 1:803 1:804 1:805 1:806 1:807 1:808 1:809 1:810 1:811 1:812 1:813 1:814 1:815 1:816 1:817 1:818 1:819 1:820 1:821 1:822 1:823 1:824 1:825 1:826 1:827 1:828 1:829 1:830 1:831 1:832 1:833 1:834 1:835 1:836 1:837 1:838 1:839 1:840 1:841 1:842 1:843 1:844 1:845 1:846 1:847 1:848 1:849 1:850 1:851 1:852 1:853 1:854 1:855 1:856 1:857 1:858 1:859 1:860 1:861 1:862 1:863 1:864 1:865 1:866 1:867 1:868 1:869 1:870 1:871 1:872 1:873 1:874 1:875 1:876 1:877 1:878 1:879 1:880 1:881 1:882 1:883 1:884 1:885 1:886 1:887 1:888 1:889 1:890 1:891 1:892 1:893 1:894 1:895 1:896 1:897 1:898 1:899 1:900 1:901 1:902 1:903 1:904 1:905 1:906 1:907 1:908 1:909 1:910 1:911 1:912 1:913 1:914 1:915 1:916 1:917 1:918 1:919 1:920 1:921 1:922 1:923 1:924 1:925 1:926 1:927 1:928 1:929 1:930 1:931 1:932 1:933 1:934 1:935 1:936 1:937 1:938 1:939 1:940 1:941 1:942 1:943 1:944 1:945 1:946 1:947 1:948 1:949 1:950 1:951 1:952 1:953 1:954 1:955 1:956 1:957 1:958 1:959 1:960 1:961 1:962 1:963 1:964 1:965 1:966 1:967 1:968 1:969 1:970 1:971 1:972 1:973 1:974 1:975 1:976 1:977 1:978 1:979 1:980 1:981 1:982 1:983 1:984 1:985 1:986 1:987 1:988 1:989 1:990 1:991 1:992 1:993 1:994 1:995 1:996 1:997 1:998 1:999 2:000		<b>Brennschnitt</b> Schnittgröße nach EN ISO 9011 1:1 1:2 1:3 1:4 1:5 1:6 1:7 1:8 1:9 1:10 1:11 1:12 1:13 1:14 1:15 1:16 1:17 1:18 1:19 1:20 1:21 1:22 1:23 1:24 1:25 1:26 1:27 1:28 1:29 1:30 1:31 1:32 1:33 1:34 1:35 1:36 1:37 1:38 1:39 1:40 1:41 1:42 1:43 1:44 1:45 1:46 1:47 1:48 1:49 1:50 1:51 1:52 1:53 1:54 1:55 1:56 1:57 1:58 1:59 1:60 1:61 1:62 1:63 1:64 1:65 1:66 1:67 1:68 1:69 1:70 1:71 1:72 1:73 1:74 1:75 1:76 1:77 1:78 1:79 1:80 1:81 1:82 1:83 1:84 1:85 1:86 1:87 1:88 1:89 1:90 1:91 1:92 1:93 1:94 1:95 1:96 1:97 1:98 1:99 2:000	<b>Form- und Längsform</b> 1:1 1:2 1:3 1:4 1:5 1:6 1:7 1:8 1:9 1:10 1:11 1:12 1:13 1:14 1:15 1:16 1:17 1:18 1:19 1:20 1:21 1:22 1:23 1:24 1:25 1:26 
--	--	--	---

**PREKLAD**  
 dne: 2.7. 07. 2012  
**PROVEDLA**  
 MICHAL SMĚJA

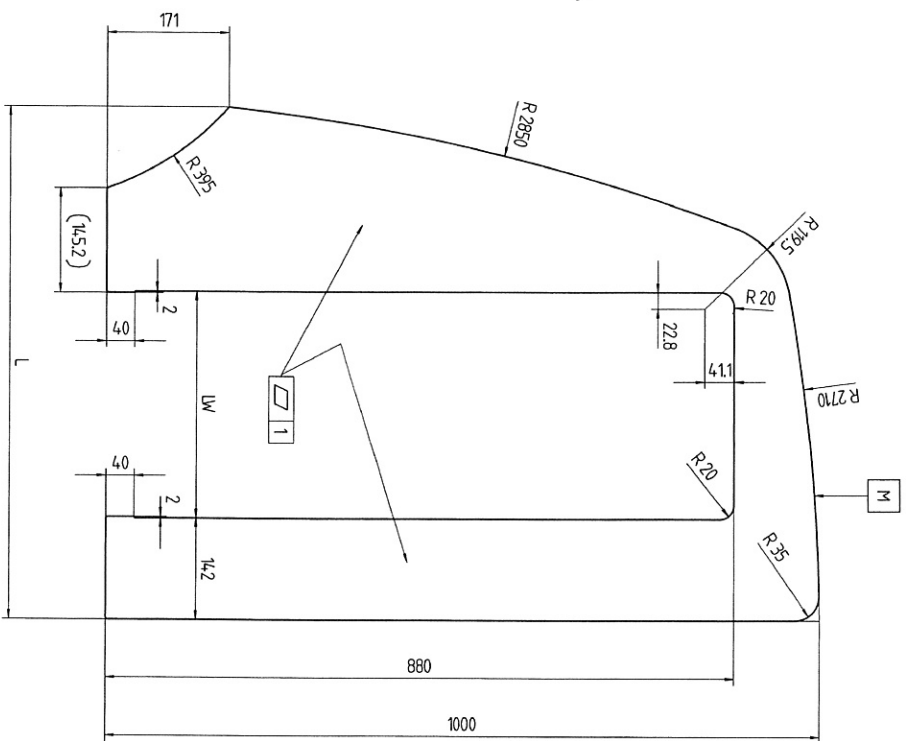

Material-Nr.	Ident-Nr.	Benennung	LW	L	Benennung	Gewicht (kg)	Änd. od. Nach. / Revision	Datum/Bearb.
5212407100	8288169	Seitenteil	316	714,5		4,03		
5212407101	8288170	Seitenteil	386	784,5		4,13		
5212407114	-	Seitenteil	316	714,5	mit Gewinde ; siehe Blatt 2	4,03		
5212407115	-	Seitenteil	386	784,5	mit Gewinde ; siehe Blatt 2	4,13	126480 / 02 Nachtrag	22.07.10 / SAM Ko

MISRO PRO  
 PÁŽBU ZNAČKY  
 MATĚJKA  
 [M] Stempel: hier  
 Kennzeichnung mit  
 Material-Nr.

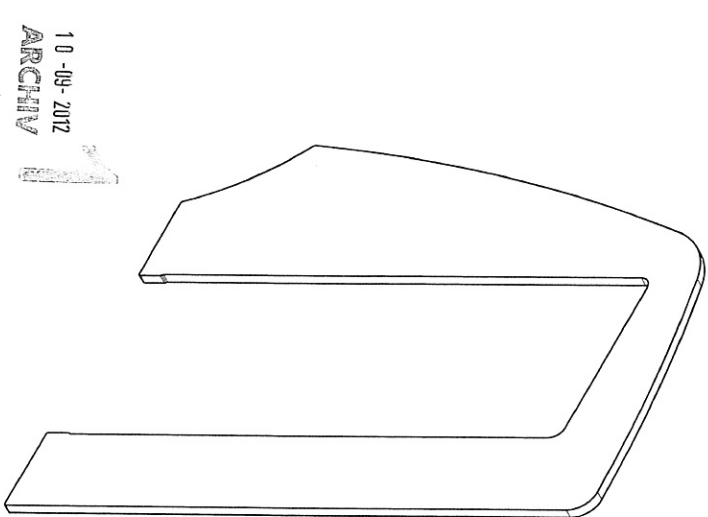

NZ12/00662

10-09-2012  
 ARCHIV

Nicht benannte Raden R=3  
 NEKOTOVANÉ POLOMĚRY R=3

Zeichnungsnummer 8288168 / STILL-RT 52128086052		Blatt: von 1 2	
Freinotation 52128086052d001		Urspr.	
Zeichnungsnummer 8288168 / STILL-RT 52128086052		Blatt: von 1 2	
Freinotation 52128086052d001		Urspr.	





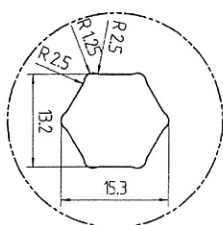

RECEIVED  
JUL 28 07 2002  
MICHAEL SHEA

Některá ne' Poloměry  
R=2  
Nicht bemessene Radien R=3

[illegible]

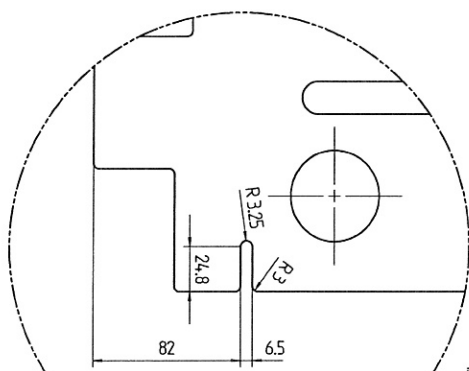

P. Muckley

nicht bemastete Radien  $R =$

+

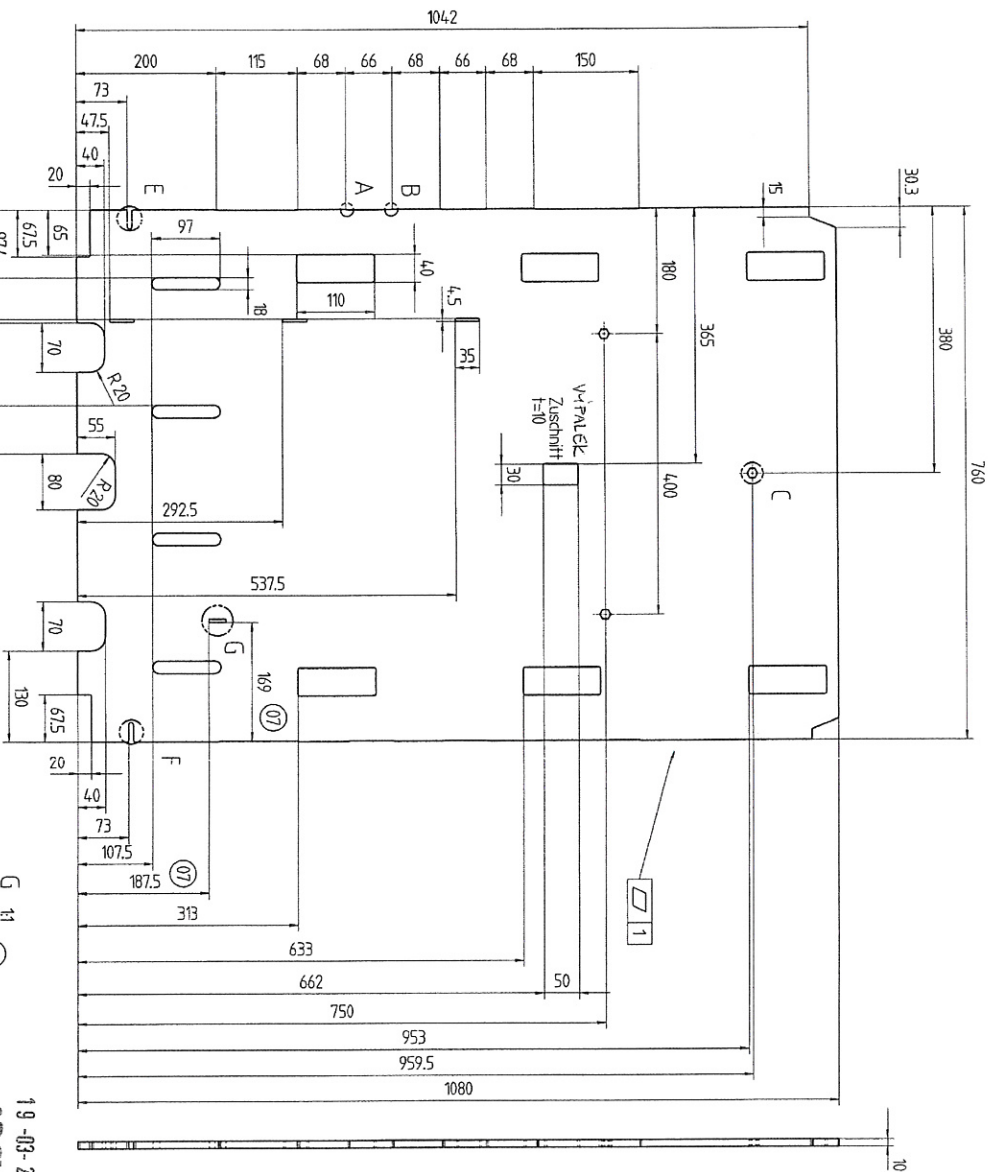
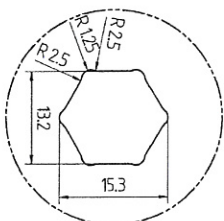

NZ12/00220

19-03-2012  
ARCHIV

NEKOTOVANÉ PULMÉRY  
R=3  
Nicht bemalte Räder R=3

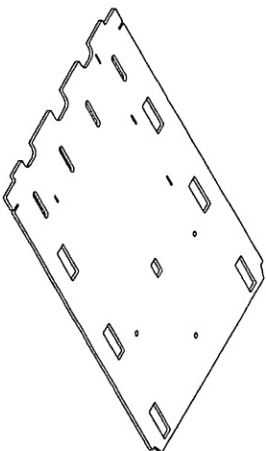
[illegible]

5

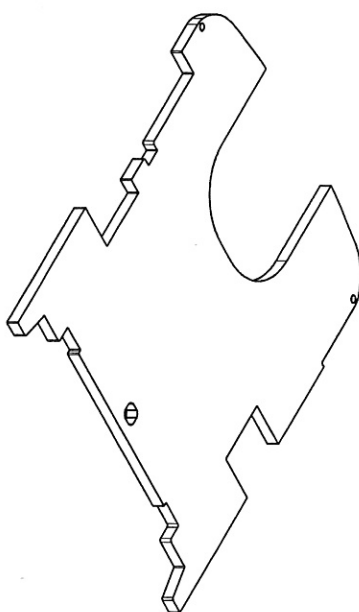
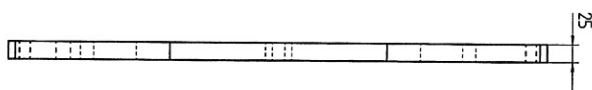

277/16/01190

Arbeitsbeschreibung  
Werkstoff: BLZS-ENT000;  
5210127262

Bodenplatte  
AB-790 EM FK-X

Summer	
--------	--

gshunt

Zeichnung 53128067330

27	3212600220
Exl.	

```

reigegeben      6

```





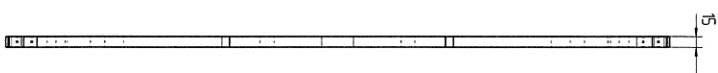
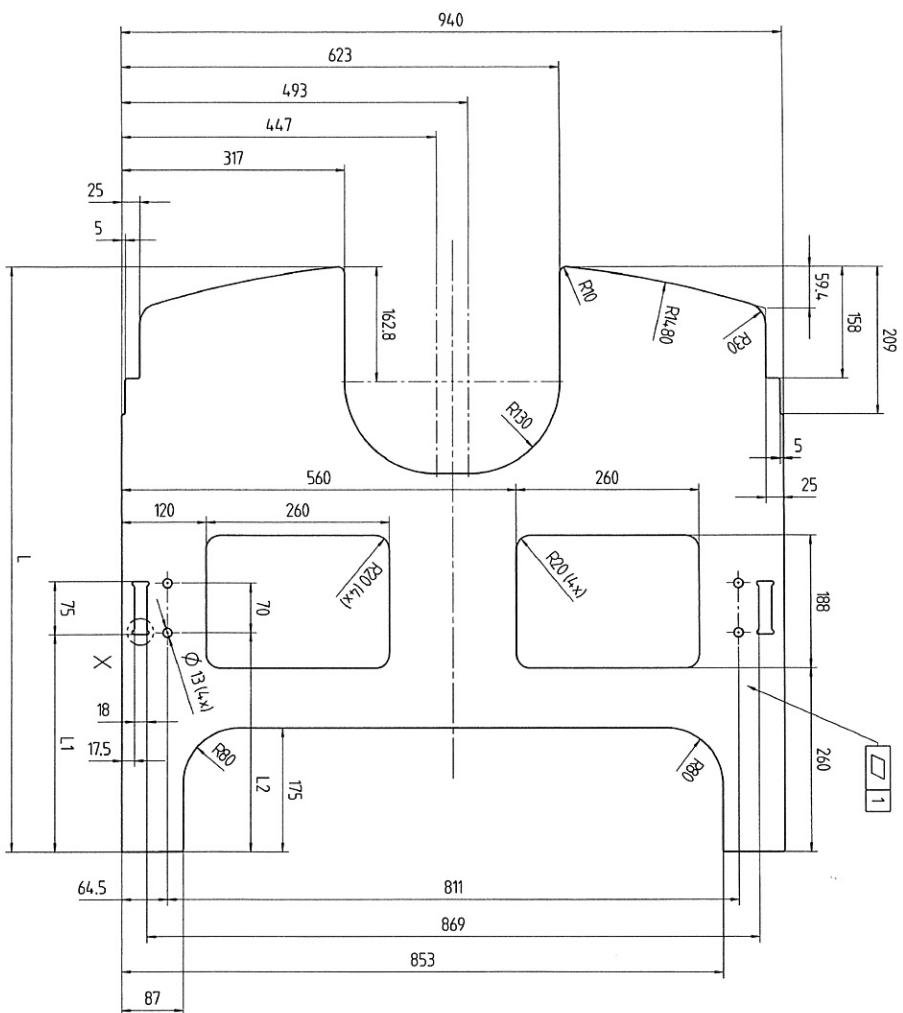

PROJEKT  
Dre: 09.10.2014  
MICAL ŠMEJA

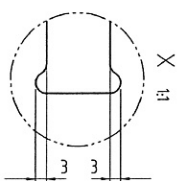

23-10-2014

ARCHIV



Nicht bemessene Radial R=3

Matr.-Nr.	Benennung	L	L1	L2	Gewicht [kg]	And. od. Nach. Revision	Datum/Bearb.
52128021208	Schablone						
52124012738	Bodenplatte AB-980, Trog-134, TE	827,8	307,5	310	51,9		
52124012739	Bodenplatte AB-980, Trog-136, TE	937,8	362,5	365	63,4		

[illegible]

freigegeber

Ur spr. 521280860	6
52128086315d001	

A2



\*\* Gewinn M6 (2x) nur bei  
52124012732  
52124012733  
52124012734  
52124012735

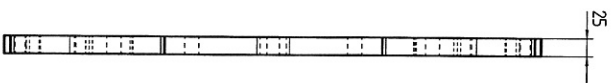

10-11-2016  
ARCHIV  
2  
2M/16/0470

Freigegeben









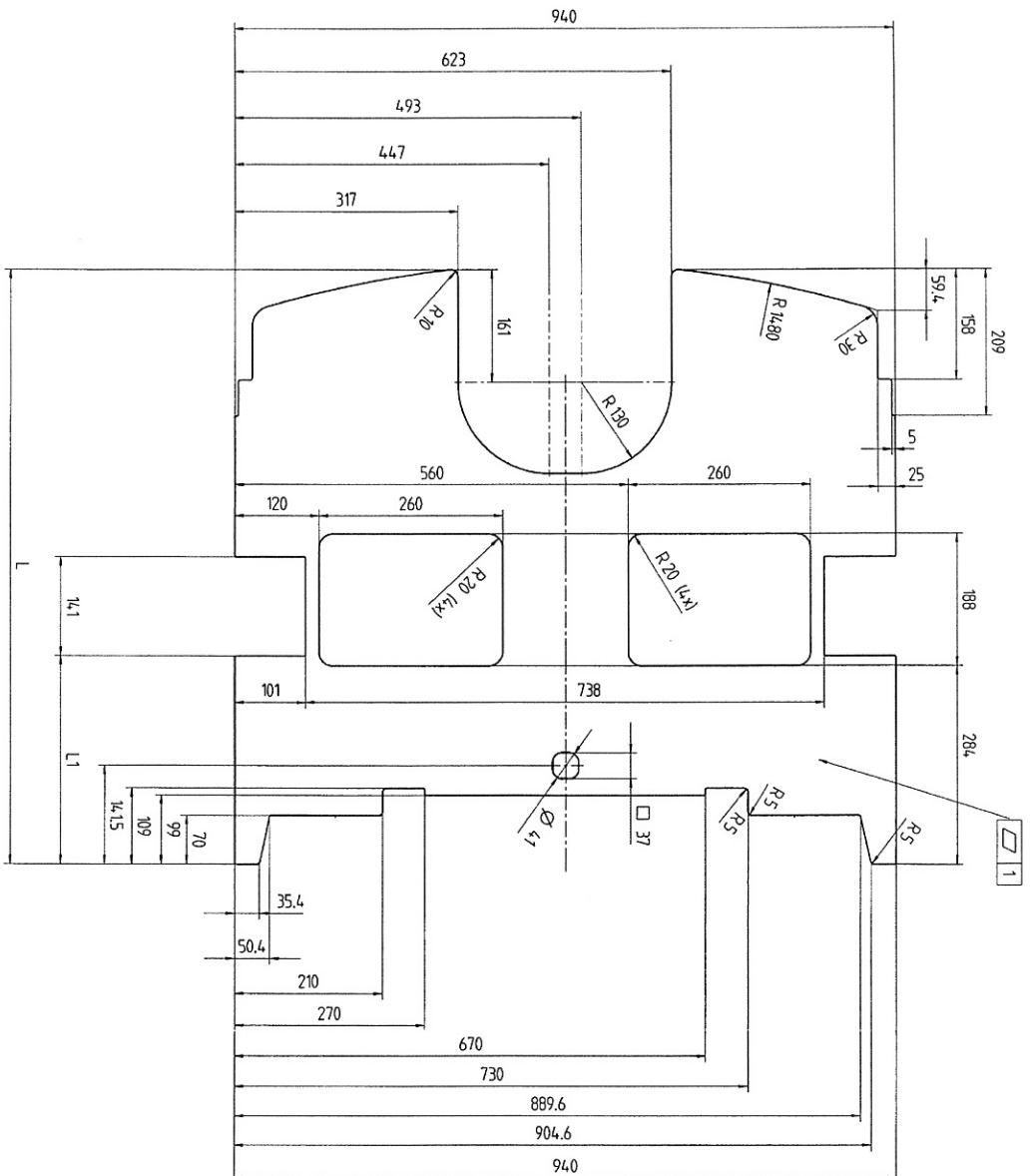

Material-Nr.	Benennung	L	L1	Gewicht kg	Datum/Bearb.
5212407212	AB-980 EM Trög 134	850	298	970	21.06.12 / SAM
5212407213	AB-980 EM Trög 136	960	353	1173	

(02)

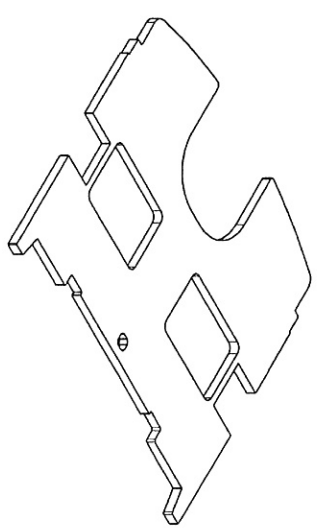
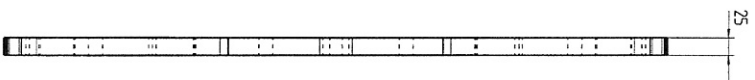

PŘEKLAD  
dne: - 4. 07. 2012  
PROVEDLÁ  
MICHAL ŠNEŽKA

17-07-2012  
ARCHIV

NEKOTROVÁČE POUŽÍVÁ R=2  
nicht benannte Raden R=2

NZ12/00589

Detailansicht der Bauteile Schnittstelle und Form von den Schnittstellen anfertigen		Maßstab: 1:1 Projektionsmethode: 1. Winkelprojektion	Blatt: 1 Gesamt: 1
Brennschnitt Schnittgröße nach EN ISO 2003 I Maßstab: 1:1 Projektionsmethode: 1. Winkelprojektion		Material: 1.3558 Zustand: R=2 Fertigung: 1.3558	Blatt: 1 Gesamt: 1
Form und Lage ISO 701 Form und Lage ISO 701 Form und Lage ISO 701		Maßstab: 1:1 Projektionsmethode: 1. Winkelprojektion	Blatt: 1 Gesamt: 1
Zeichnungsnummer 52128086219		Serie 15	Blatt: 1 Gesamt: 1

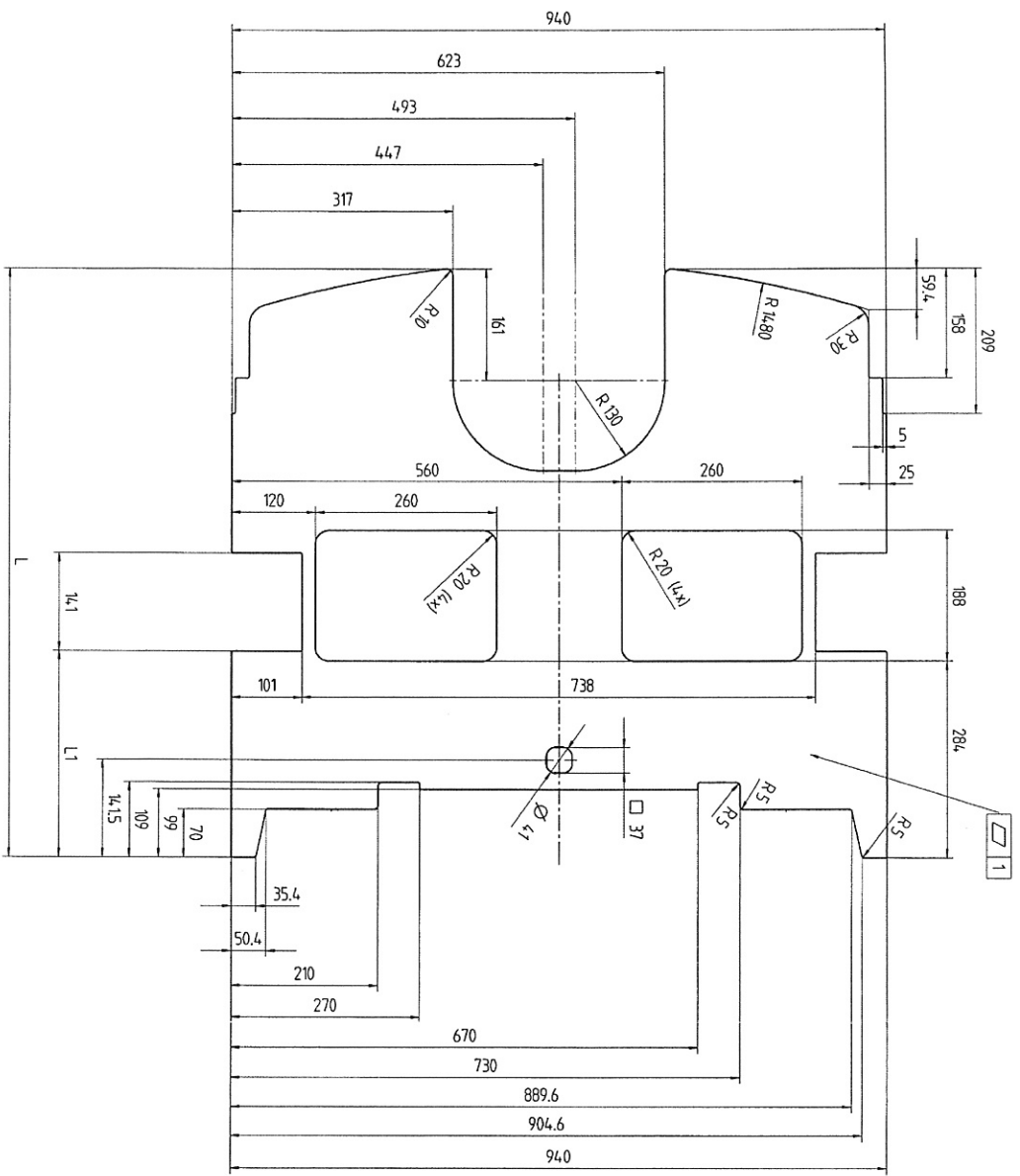

Material-Nr.	Benennung	L	L1	Gewicht kg	Datum/Beach.
5272402712	AB-980 EM Trog 134	850	298	970	
5272402713	AB-980 EM Trog 136	960	353	1173	

(02)

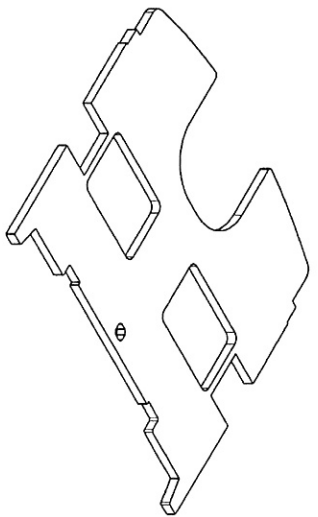
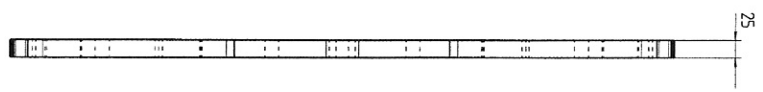

PŘEKLAD  
dne: - 4. 07. 2012  
PROVEDL/A  
MICHAL SMĚJA

17-07-2012  
ARCHIV  
NEKOTUVNÉ PLOŠNÉ R-2  
NZ12/00589

nicht demontable Raden R-2

Designdaten Zeichnungs-Nr.: 5272402712 Projekt-Nr.: 5272402712 Zeichnungs-Nr.: 5272402712 Projekt-Nr.: 5272402712		Ausführung Zeichnungs-Nr.: 5272402712 Projekt-Nr.: 5272402712	
Material 5272402712 5272402713		Zeichnungs-Nr.: 5272402712 Projekt-Nr.: 5272402712	
Benennung AB-980 EM Trog 134 AB-980 EM Trog 136		Zeichnungs-Nr.: 5272402712 Projekt-Nr.: 5272402712	
L 850 960		Zeichnungs-Nr.: 5272402712 Projekt-Nr.: 5272402712	
L1 298 353		Zeichnungs-Nr.: 5272402712 Projekt-Nr.: 5272402712	
Gewicht kg 970 1173		Zeichnungs-Nr.: 5272402712 Projekt-Nr.: 5272402712	
Datum/Beach. 21.06.12 / SAM		Zeichnungs-Nr.: 5272402712 Projekt-Nr.: 5272402712	



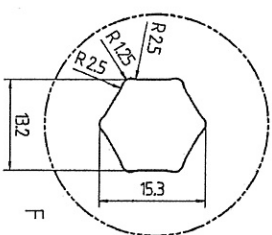

**PŘEKLAD**  
dne: - 7 -10- 2016  
*Ad PROVEDLIA*  
*JANA PROKEŠOVÁ*

8X11/16/07034

ARCHIV  
- 7 - 10 - 2016

НЕКОТОРЫЕ ПОЛОНЕРЫ R=3  
nicht bemessene Radien R=3

[illegible]



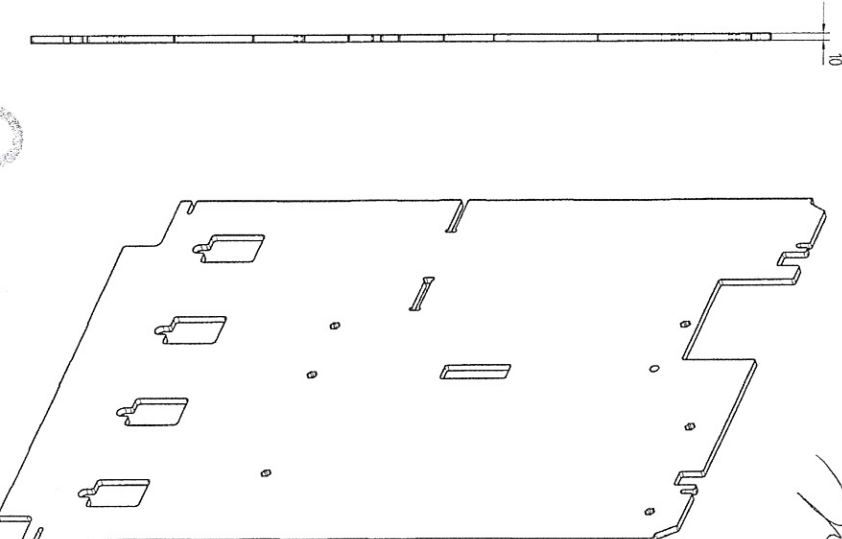



























































































PROVEDVA  
MICHAL SMEJA  
dne: - 9. 02. 2011



NEKOTOVANÉ POLOMĚRY  $R=3$   
nicht bemalte Radien  $R=3$

NZ 11/00239

15. Produkt-ID 152 	15.1 Programmiersprache 	15.2 	15.3 	15.4 	15.5 	15.6 	15.7 	15.8 	15.9 	15.10 	15.11 	15.12 
16. Produkt-ID 162 	16.1 Programmiersprache 	16.2 	16.3 	16.4 	16.5 	16.6 	16.7 	16.8 	16.9 	16.10 	16.11 	16.12 
17. Produkt-ID 172 	17.1 Programmiersprache 	17.2 	17.3 	17.4 	17.5 	17.6 	17.7 	17.8 	17.9 	17.10 	17.11 	17.12 
18. Produkt-ID 182 	18.1 Programmiersprache 	18.2 	18.3 	18.4 	18.5 	18.6 	18.7 	18.8 	18.9 	18.10 	18.11 	18.12 
19. Produkt-ID 192 	19.1 Programmiersprache 	19.2 	19.3 	19.4 	19.5 	19.6 	19.7 	19.8 	19.9 	19.10 	19.11 	19.12 
20. Produkt-ID 202 	20.1 Programmiersprache 	20.2 	20.3 	20.4 	20.5 	20.6 	20.7 	20.8 	20.9 	20.10 	20.11 	20.12 
21. Produkt-ID 212 	21.1 Programmiersprache 	21.2 	21.3 	21.4 	21.5 	21.6 	21.7 	21.8 	21.9 	21.10 	21.11 	21.12 
22. Produkt-ID 222												